

Courses & Dist. up river  
from Sassafras

- N. 39. E. 50
- N. 51. E. 33
- N. 55 1/2. E. 112
- N. 60. E. 28
- N. 63 1/2. E. 46
- N. 47. E. 34
- N. 70. E. 24 to Beech.

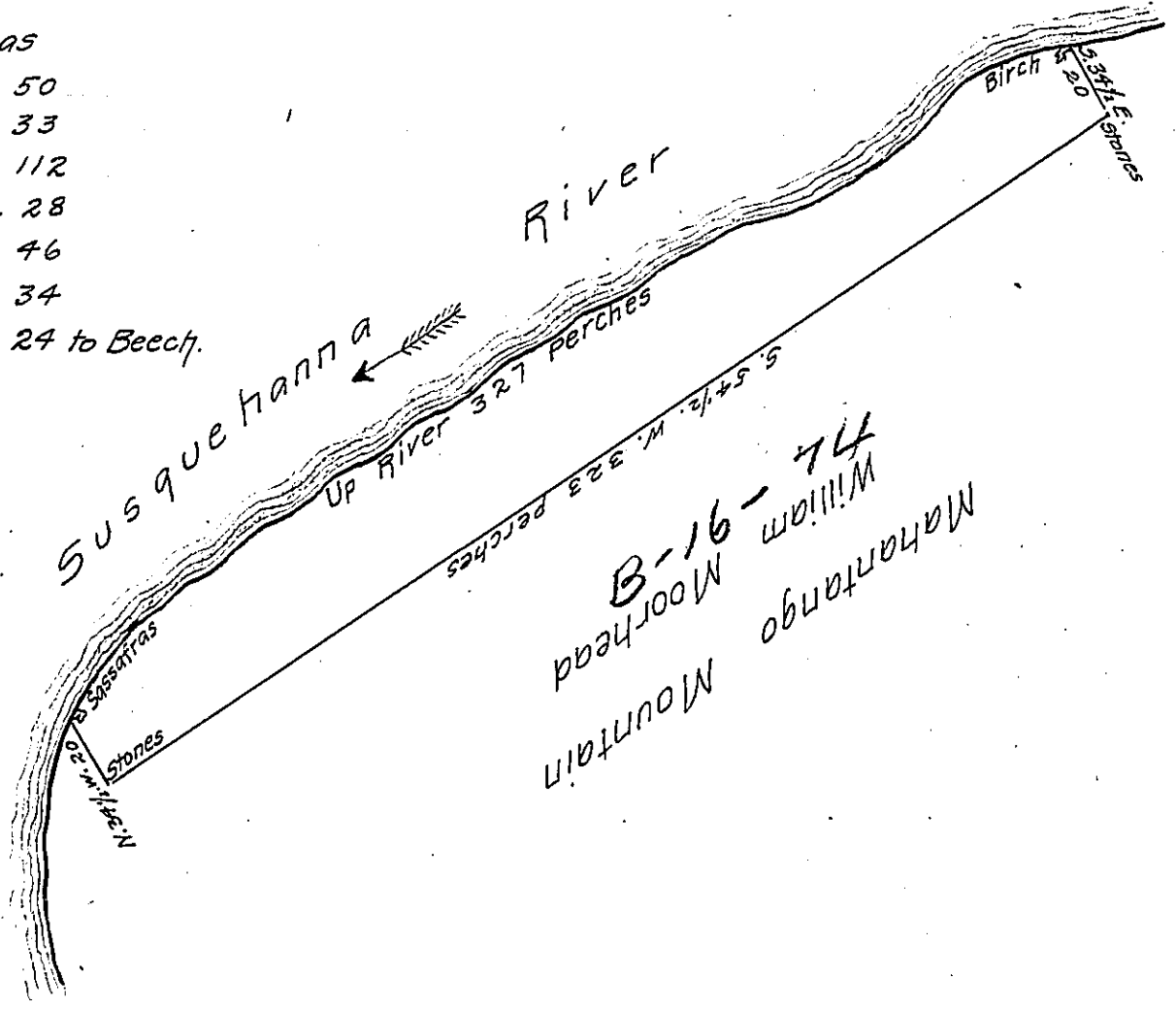

Surveyed the 2 day of July 1813 for Henry Meck the above described tract of land situate in Upper Paxton Township Dauphin County by the original Boundaries, including the greater part of the narrows of Mahantango Mountain containing fifty three acres & allve of six per cent on Warrant of George Weaver dated the 10th. day of December 1785.

Thomas Smith D.S.

To Andrew Porter Esquire }  
Surveyor General Pa. }

IN TESTIMONY that the above is a copy of the original remaining on file in the Department of Internal Affairs of Pennsylvania, made comformably to an Act of Assembly approved the 16th day of February 1833, I have hereunto set my hand and caused the Seal of said Department to be affixed at Harrisburg, this thirtieth day of April 1907

*Isaac D. Brown*  
Secretary of Internal Affairs.